

RACCORDERIA PER ALA GOCCIOLANTE CON ANELLINO ELASTICO

DRIPLINE FITTINGS WITH ELASTIC RING

PER TUBI IN PE DI SPESSORE DA 0.90 A 1.30 MM (DA 35 A 50 MIL) / FOR PE PIPES WITH THICKNESS FROM 0.90 TO 1.30 MM (FROM 35 TO 50 MIL)

CARATTERISTICHE TECNICHE TECHNICAL FEATURES

MATERIALI IMPIEGATI / RAW MATERIALS

Corpo/body : PP + anti-UV
Anellino/ring : POM + anti-UV

FILETTATURE / THREADS

UNI EN 10226
(ex ISO 7/1)

Per tubi in PE di spessore da 0.90 a 1.30 mm (da 35 a 50 mil)
For PE pipes with thickness from 0.90 to 1.30 mm (from 35 to 50 mil)

I dati del presente catalogo, hanno titolo puramente indicativo e non sono vincolanti. La Plast Project S.r.l. si riserva il diritto, anche senza preavviso, di effettuare modifiche ai prodotti, ai fini del loro miglioramento tecnico.

The specifications in this document are to be considered merely informative and are not binding. Plast Project S.r.l. reserves its right to carry out all the modifications which are considered necessary in accordance with technical improvement.

RACCORDERIA PER ALA GOCCIOLANTE CON ANELLINO ELASTICO

DRIPLINE FITTINGS WITH ELASTIC RING

PER TUBI IN PE DI SPESSORE DA 0.90 A 1.30 MM (DA 35 A 50 MIL) / FOR PE PIPES WITH THICKNESS FROM 0.90 TO 1.30 MM (FROM 35 TO 50 MIL)

3310

CODE	Ø	LT	F	D1	DA	D2
3310.0160	16-16	61.9	9.8	13.8	15.2	15.8
3310.0200	20-20	64.1	13.9	18.2	19.6	20.2

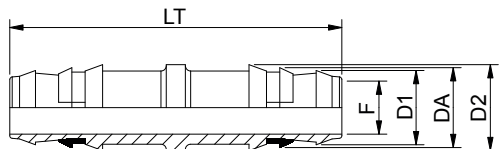

3312

CODE	Ø	LT	F	D1	DA	D2	FR	D1R	DAR	D2R
3312.2016	20-16	63.0	13.9	18.2	19.6	20.2	9.8	13.8	15.2	15.8

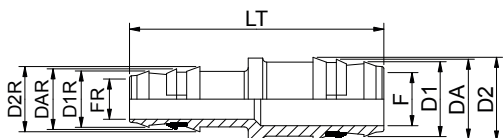

3314

CODE	Ø	LT	F	D1	DA	D2	FF	DF	LF	LO
3314.016C	16-1/2"	52.3	9.8	13.8	15.2	15.8	14.0	1/2"	15.3	8.0
3314.016D	16-3/4"	56.3	9.8	13.8	15.2	15.8	18.3	3/4"	17.3	10.0
3314.020C	20-1/2"	53.3	13.9	18.2	19.6	20.2	14.0	1/2"	15.3	8.0
3314.020D	20-3/4"	57.3	13.9	18.2	19.6	20.2	18.3	3/4"	17.3	10.0

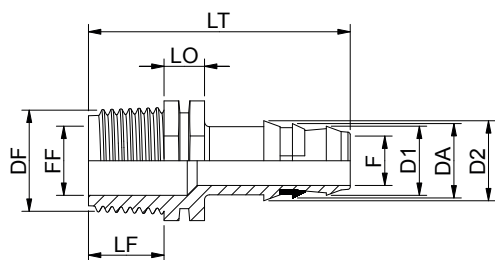

3322

CODE	Ø	LT	F	D1	DA	D2	FD	DC	DT
3322.0160	16-D	48.7	9.8	13.8	15.2	15.8	8.9	14.0	16.8
3322.0200	20-D	49.8	13.9	18.2	19.6	20.2	8.9	14.0	16.8

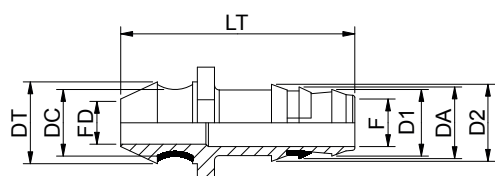

RACCORDERIA PER ALA GOCCIOLANTE CON ANELLINO ELASTICO

DRIPLINE FITTINGS WITH ELASTIC RING

PER TUBI IN PE DI SPESSORE DA 0.90 A 1.30 MM (DA 35 A 50 MIL) / FOR PE PIPES WITH THICKNESS FROM 0.90 TO 1.30 MM (FROM 35 TO 50 MIL)

3325

CODE	Ø	LT	F	D1	DA	D2	FD	DG	DT
3325.0160	16-D	50.9	9.8	13.8	15.2	15.8	8.9	11.8	14.0
3325.0200	20-D	52.0	13.9	18.2	19.6	20.2	8.9	11.8	14.0

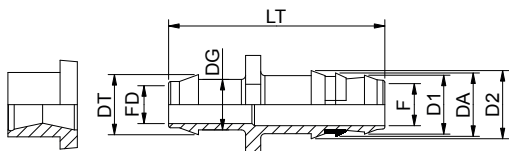

3326

CODE	Ø	LT	F	D1	DA	D2	FD	DG	DT	LF
3326.0160	16-D	66.8	9.8	13.8	15.2	15.8	7.9	11.4	14.0	14.0
3326.0200	20-D	67.9	13.9	18.2	19.6	20.2	7.9	11.4	14.0	14.0

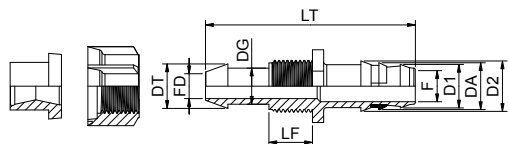

3332

CODE	Ø	LT	F	D1	DA	D2
3332.0160	16	34.8	9.8	13.8	15.2	15.8
3332.0200	20	36.3	13.9	18.2	19.6	20.2

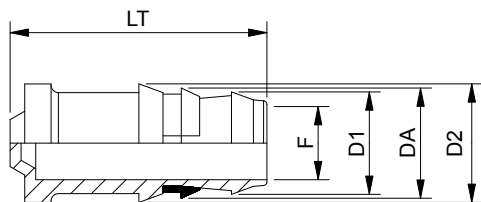

3334

CODE	Ø	LT	F	D1	DA	D2	F1	D3	D4
3334.1616	16-16	60.6	9.8	13.8	15.2	15.8	9.8	14.8	15.6
3334.1620	16-20	61.7	13.9	18.2	19.6	20.2	9.8	14.8	15.6
3334.2016	20-16	60.2	9.8	13.8	15.2	15.8	13.9	19.0	20.0
3334.2020	20-20	62.0	13.9	18.2	19.6	20.2	13.9	19.0	20.0
3334.2516	25-16	68.0	9.8	13.8	15.2	15.8	18.2	24.0	25.0
3334.2520	25-20	69.1	13.9	18.2	19.6	20.2	18.2	24.0	25.0

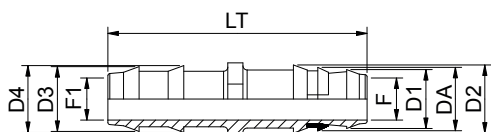

RACCORDERIA PER ALA GOCCIOLANTE CON ANELLINO ELASTICO

DRIPLINE FITTINGS WITH ELASTIC RING

PER TUBI IN PE DI SPESSORE DA 0.90 A 1.30 MM (DA 35 A 50 MIL) / FOR PE PIPES WITH THICKNESS FROM 0.90 TO 1.30 MM (FROM 35 TO 50 MIL)

3350

CODE	Ø	LT	F	D1	DA	D2
3350.0160	16-16-16	90.1	9.8	13.8	15.2	15.8
3350.0200	20-20-20	92.3	13.9	18.2	19.6	20.2

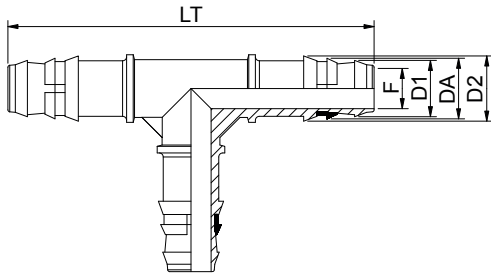

3352

CODE	Ø	LT	F	D1	DA	D2	FR	D1R	DAR	D2R
3352.1620	20-16-20	92.3	13.9	18.2	19.6	20.2	9.8	13.8	15.2	15.8
3352.2016	16-20-16	90.1	9.8	13.8	15.2	15.8	13.9	18.2	19.6	20.2

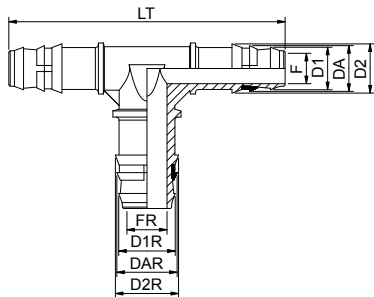

3354

CODE	Ø	LT	F	D1	DA	D2	FF	DF	LF
3354.016C	16-1/2"-16	90.1	9.8	13.8	15.2	15.8	14.0	1/2"	15.3
3354.016D	16-3/4"-16	90.1	9.8	13.8	15.2	15.8	18.3	3/4"	17.3
3354.020C	20-1/2"-20	92.3	13.9	18.2	19.6	20.2	14.0	1/2"	15.3
3354.020D	20-3/4"-20	92.3	13.9	18.2	19.6	20.2	18.3	3/4"	17.3

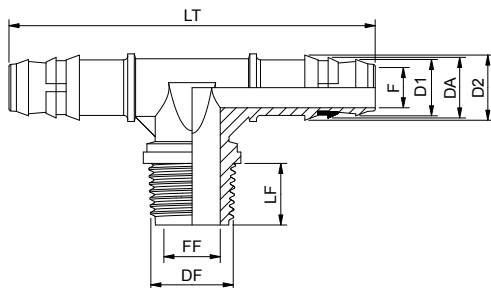

3360

CODE	Ø	LT	F	D1	DA	D2	FD	DC	DT
3360.0160	16-D-16	90.1	9.8	13.8	15.2	15.8	8.9	14.0	16.8
3360.0200	20-D-20	92.3	13.9	18.2	19.6	20.2	8.9	14.0	16.8

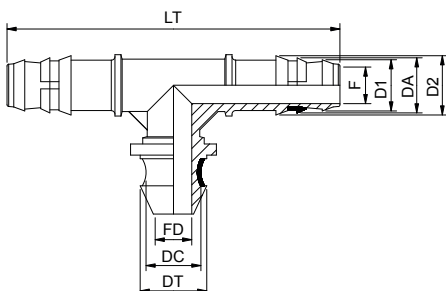

RACCORDERIA PER ALA GOCCIOLANTE CON ANELLINO ELASTICO

DRIPLINE FITTINGS WITH ELASTIC RING

PER TUBI IN PE DI SPESSORE DA 0.90 A 1.30 MM (DA 35 A 50 MIL) / FOR PE PIPES WITH THICKNESS FROM 0.90 TO 1.30 MM (FROM 35 TO 50 MIL)

3362

CODE	Ø	LT	F	D1	DA	D2	FD	DC	DT
3362.0160	16-DXL-16	90.1	9.8	13.8	15.2	15.8	14.0	19.0	21.8
3362.0200	20-DXL-20	92.3	13.9	18.2	19.6	20.2	14.0	19.0	21.8

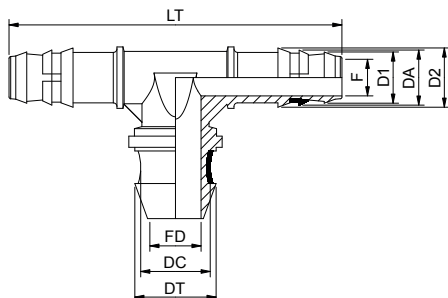

3368

CODE	Ø	LT	F	D1	DA	D2	F1	D3	D4
3368.1616	16-16-16	90.1	9.8	13.8	15.2	15.8	9.8	14.8	15.6
3368.1620	20-16-20	92.3	13.9	18.2	19.6	20.2	9.8	14.8	15.6
3368.2020	20-20-20	92.3	13.9	18.2	19.6	20.2	13.9	19.0	20.0
3368.2516	16-25-16	90.1	9.8	13.8	15.2	15.8	18.2	24.0	25.0
3368.2520	20-25-20	92.3	13.9	18.2	19.6	20.2	18.2	24.0	25.0

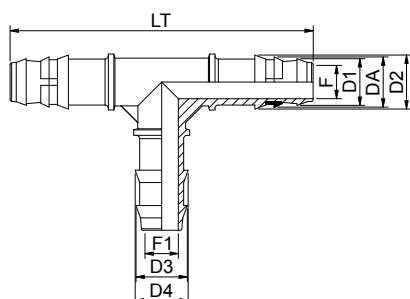

3370

CODE	Ø	LT	F	D1	DA	D2	F1	D3	D4
3370.1616	16-16-16	87.3	9.8	13.8	15.2	15.8	9.8	14.8	15.6
3370.1620	20-16-20	87.9	9.8	13.8	15.2	15.8	13.9	19.0	20.0
3370.1625	25-16-25	102.1	9.8	13.8	15.2	15.8	18.2	24.0	25.0
3370.2016	16-20-16	87.3	13.9	18.2	19.6	20.2	9.8	14.8	15.6
3370.2025	25-20-25	102.1	13.9	18.2	19.6	20.2	18.2	24.0	25.0

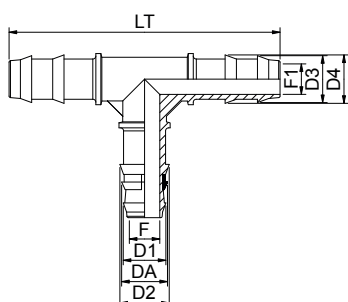

3380

CODE	Ø	F	D1	DA	D2
3380.0160	16-16	9.8	13.8	15.2	15.8
3380.0200	20-20	13.9	18.2	19.6	20.2

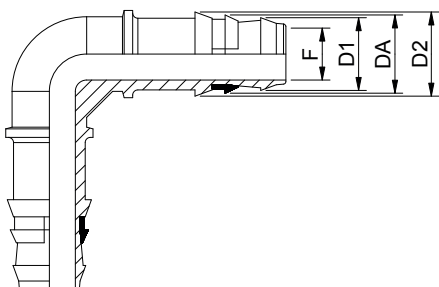

RACCORDERIA PER ALA GOCCIOLANTE CON ANELLINO ELASTICO

DRIPLINE FITTINGS WITH ELASTIC RING

PER TUBI IN PE DI SPESSORE DA 0.90 A 1.30 MM (DA 35 A 50 MIL) / FOR PE PIPES WITH THICKNESS FROM 0.90 TO 1.30 MM (FROM 35 TO 50 MIL)

3382

CODE	Ø	F	D1	DA	D2	F1	D1R	DAR	D2R
3382.2016	20-16	9.8	13.8	15.2	15.8	13.9	18.2	19.6	20.2

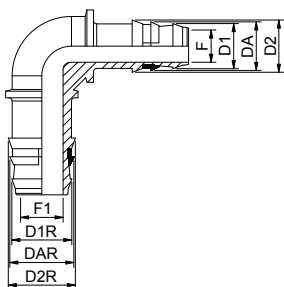

3384

CODE	Ø	F	D1	DA	D2	FF	DF	LF
3384.016C	16-1/2"	9.8	13.8	15.2	15.8	14.0	1/2"	15.3
3384.016D	16-3/4"	9.8	13.8	15.2	15.8	18.3	3/4"	17.3
3384.020C	20-1/2"	13.9	18.2	19.6	20.2	14.0	1/2"	15.3
3384.020D	20-3/4"	13.9	18.2	19.6	20.2	18.3	3/4"	17.3

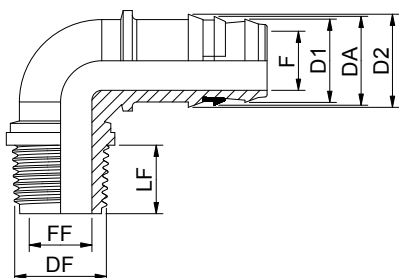

3390

CODE	Ø	F	D1	DA	D2	FD	DC	DT
3390.0160	16-D	9.8	13.8	15.2	15.8	8.9	14.0	16.8
3390.0200	20-D	13.9	18.2	19.6	20.2	8.9	14.0	16.8

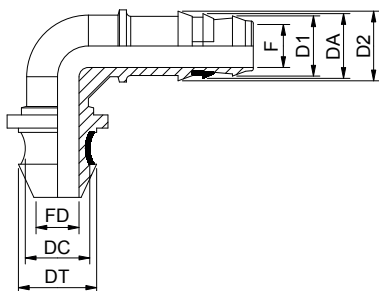

3392

CODE	Ø	F	D1	DA	D2	FD	DC	DT
3392.0200	20-DXL	13.9	18.2	19.6	20.2	14.0	19.0	21.8

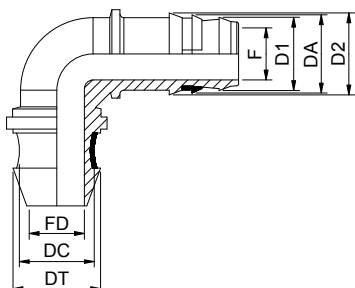

RACCORDERIA PER ALA GOCCIOLANTE CON ANELLINO ELASTICO

DRIPLINE FITTINGS WITH ELASTIC RING

PER TUBI IN PE DI SPESSORE DA 0.90 A 1.30 MM (DA 35 A 50 MIL) / FOR PE PIPES WITH THICKNESS FROM 0.90 TO 1.30 MM (FROM 35 TO 50 MIL)

3394

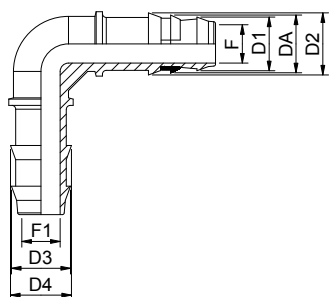

CODE	Ø	F	D1	DA	D2	F1	D3	D4
3394.1616	16-16	9.8	13.8	15.2	15.8	9.8	14.8	15.6
3394.1620	16-20	13.9	18.2	19.6	20.2	9.8	14.8	15.6
3394.2016	20-16	9.8	13.8	15.2	15.8	13.9	19.0	20.0
3394.2020	20-20	13.9	18.2	19.6	20.2	13.9	19.0	20.0
3394.2516	25-16	9.8	13.8	15.2	15.8	18.2	24.0	25.0
3394.2520	25-20	13.9	18.2	19.6	20.2	18.2	24.0	25.0